

SPECIFICATION



| | | | |
|----------------|---------|--------------------|------------|
| LOA | | 17.60 m | 57' 9" |
| Hull length | | 16.90 m | 55' 5" |
| LWL | | 16.26 m | 53' 4" |
| Beam | | 5.30 m | 17' 5" |
| Draft | | | |
| shallow keel | | 2.18 m | 7' 2" |
| L-keel, medium | | 2.53 m | 8' 4" |
| Displacement | | | |
| shallow keel | approx. | 23.50 t | 51,808 lbs |
| L-keel, medium | approx. | 22.90 t | 50,486 lbs |
| Ballast | | | |
| shallow keel | approx. | 6.50 t | 14,330 lbs |
| L-keel, medium | approx. | 5.90 t | 13,007 lbs |
| Engine Diesel | | | |
| standard | approx. | 110 PS | 110 hp |
| option | approx. | 150 PS | 150 hp |
| Fuel tank | approx. | 520 l | 137 gal |
| Fresh water | approx. | 770 l | 203 gal |
| CE Certificate | | A - 12 | |
| Design | | Berret - Racoupeau | |
| Interior | | Berret - Racoupeau | |

| | | | |
|----------------------|---------|-----------------------|-------------|
| Mast length above WL | approx. | 26.27 m | 86' 2" |
| Total sail area | approx. | 151.00 m ² | 1,625 sq ft |
| Main sail | | | |
| standard | approx. | 91.00 m ² | 979 sq ft |
| furling mast | approx. | 81.00 m ² | 872 sq ft |
| Jib | approx. | 60.00 m ² | 646 sq ft |
| Reacher | approx. | 112.00 m ² | 1,205 sq ft |
| Gennaker | approx. | 235.00 m ² | 2,529 sq ft |

590

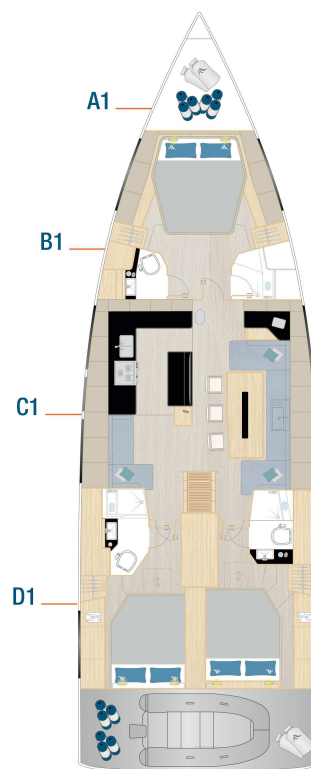
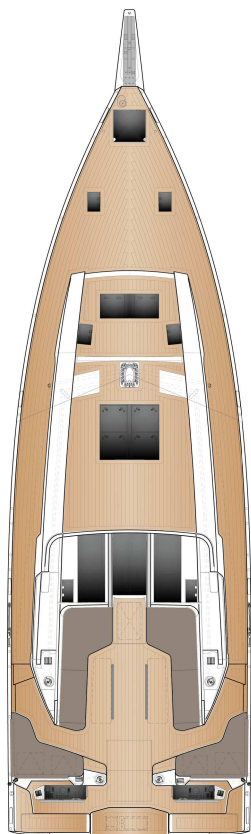

Standard

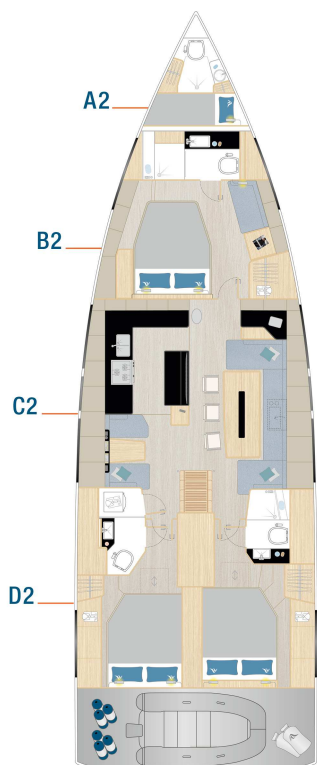

Option

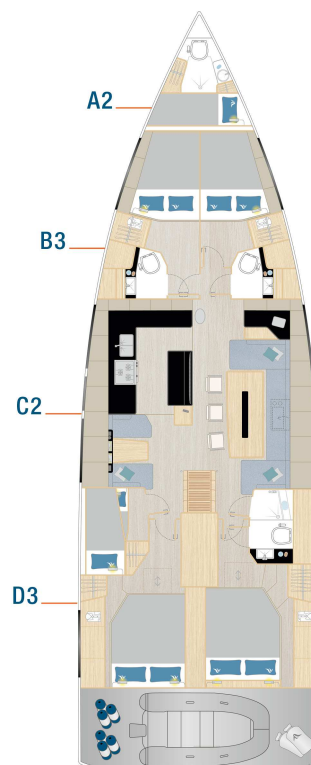

Option

HULL

- 8 hull windows (4 each side)
- GRP hull, isophthalic gelcoat, colour: Signal White (similar RAL 9003), 1st layer vinyl ester resin with PVC foam core built in vacuum infusion
- Waterline, isophthalic gelcoat, colour: Dark Grey (similar RAL 7043)

KEEL

- L-keel, cast iron, draft: 2.53 m
- GRP rudder with sea-water resistant aluminium shaft and selfaligning bearings

LAYOUT & INTERIOR

- A1: Sail locker with extensive storage space
- B1: Master cabin with island double berth, storage space and a head with separate shower stall
- C1: Saloon with full functional island galley and lounge area on port, dining area and multifunction area on stb
- D1: 2 aft cabins with double berth, storage space and ensuite head with separate shower on each cabin
- 3-burner gas stove with oven, waste bin, 12 V fridge approx. 140 l, double stainless steel sink with mixing tap
- Interior furniture in high quality marine plywood, Satin Varnish
- Hanse companionway closing system
- Saloon table, fixed
- Worktop in galley - Off White

WOOD (FURNITURE, FLOORBOARD)

- Furniture - Mahogany Style, Satin Varnish
- Cupboard fronts in wood colour
- Floorboard - Acacia
- Floorboard - wooden grating in all showers

UPHOLSTERY

- Mattresses for all berths
- Upholstery - Monte Carlo, colour: Cream

DECK & OUTSIDE EQUIPMENT

- GRP deck with antislip surface, isophthalic gelcoat, colour: Signal White (similar RAL 9003), 1st layer vinyl ester resin with balsa sandwich core. Cockpit locker on each side, dinghy garage, stowage for running rigging at helm position, anchor locker at bow.

- Synthetic teak on cockpit bottom (colour selection)
- Synthetic teak on cockpit benches (colour selection)
- Synthetic teak on bathing platform (colour selection)
- Twin wheel steering system
- 2 stainless steel steering wheels with leather cover
- 2 cockpit tables, stainless steel foot with teak tops
- Pulpit and pushpit, stainless steel
- Railing, incl. stanchions and stainless steel wire with gateway stanchion
- Covered halyards and control lines lead to cockpit helmposition, organizers and jammers, 4 retractable mooring cleats, handrails on coach roof
- 2 LEWMAR 65 ST EVO manual halyard winches
- 2 LEWMAR 65 ST EVO manual secondary winches
- Bathing platform, hydraulic fold-out, remote control and swimming ladder
- Anchor windlass, electrical, 1500 W, automatic fuse, remote control with chain counter
- Composite bowsprit with integrated anchor and forestay fitting
- Self tacking jib system
- Mainsheet system
- 7 big and 6 small deck hatches - openable
- 8 deck coach roof windows - openable, glass next to companionway

RIG & SAILS

- Rig, anodized aluminium, keel stepped, with kicker, standing and running rigging and 2 reefs
- Backstay tensioner, manual
- Manual jib furler
- GRP Targa arch, gelcoat colour: White, with main sheet base
- ELVSTRØM Dacron sails - full battened, main and jib

NAVIGATION & INSTRUMENTS

- Illuminated compass at each helm station
- Navigation lights - LED

PROPULSION

- Fuel tank, approx. 520 l
- Engine (Diesel, approx. 110 hp) - saildrive, 3-blade folding propeller

EQUIPMENT

- 12 V and 230 V electric system with main panels and 230 V shore power and sockets in cabins and heads
- AGM battery set, capacity: 1x 90 Ah + 2x 160 Ah AGM
- Country Version: EU / AUS
- Battery charger
- Manual toilet with sea water flush - cabin layout B1
- 2 manual toilets with sea water flush - cabin layout D1
- Shower unit in cockpit, warm-/coldwater
- LPG gas system, stowage for 2 gas bottles
- Black water system (appr. 85 l per head) with deck extraction and seacock for head, electric and manual bilge pump
- Fresh water system with electric pump and 40 l hotwater, heated also by main engine
- Fresh water tank, appr. 770 l

ACCESSORIES

- Blinds for hull windows
- Mast steps

SHIPPING & TRANSPORT

- CE - Certificate cat. A - 12 / B - 16 / C - 20
- Owners manual
- EC - Type Examination Certificate